

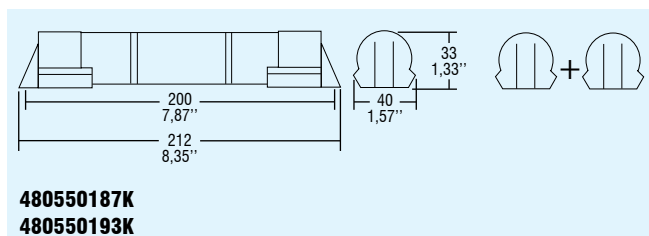

| Code<br>Codice | Ni-Cd BATTERY                        |                                    |                                     | Ni-MH BATTERY                      |                                    |                                     | BOX 1h | BOX 3h |
|----------------|--------------------------------------|------------------------------------|-------------------------------------|------------------------------------|------------------------------------|-------------------------------------|--------|--------|
|                | 7,2 V - 1,6 Ah<br>COMPACT - COMPATTI | 7,2 V - 4 Ah<br>COMPACT - COMPATTI | 2x 3,6 V - 4 Ah<br>LINEAR - LINEARE | 7,2 V - 2 Ah<br>COMPACT - COMPATTI | 7,2 V - 4 Ah<br>COMPACT - COMPATTI | 2x 3,6 V - 4 Ah<br>LINEAR - LINEARE |        |        |
| 480550189      | ✓                                    |                                    |                                     |                                    |                                    |                                     |        |        |
| 480550190      |                                      | ✓                                  |                                     |                                    |                                    |                                     |        |        |
| 480550187K     |                                      |                                    | ✓                                   |                                    |                                    |                                     |        |        |
| 123009/172     | ✓                                    |                                    |                                     |                                    |                                    |                                     | ✓      |        |
| 123009/372     |                                      | ✓                                  |                                     |                                    |                                    |                                     |        | ✓      |
| 480550191      |                                      |                                    |                                     | ✓                                  |                                    |                                     |        |        |
| 480550192      |                                      |                                    |                                     |                                    | ✓                                  |                                     |        |        |
| 480550193K     |                                      |                                    |                                     |                                    |                                    | ✓                                   |        |        |
| 123009/172MH   |                                      |                                    |                                     | ✓                                  |                                    |                                     | ✓      |        |
| 123009/372MH   |                                      |                                    |                                     |                                    | ✓                                  |                                     |        | ✓      |

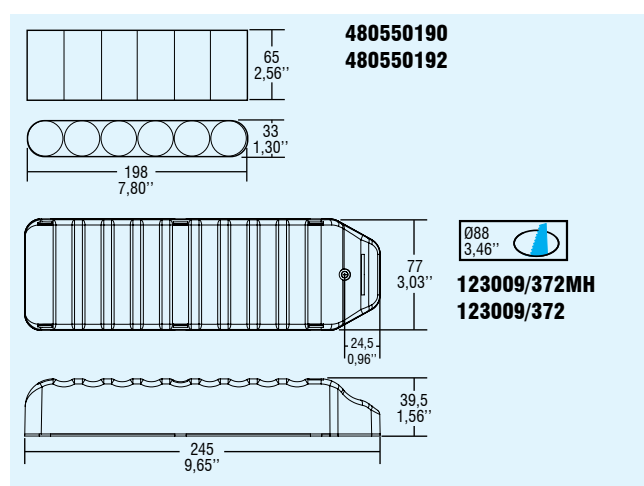
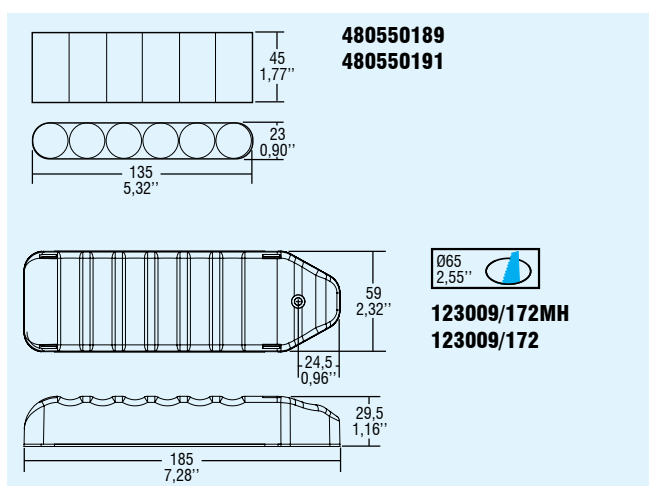

## BATTERY

### Rechargeable high temperature Ni-Cd and Ni-MH batteries.

These cells accept a permanent charge for a minimum of 4 years in high-temperature environments (up to +50°C) such as security lighting equipment.

- Constant current during charge (ELDN T).
- Intermitend current during charge (ELED).
- Zero maintenance.
- Long cycle life (over 500 charge discharge cycles).
- Long term storage (up to 4 months in normal conditions: temperature range from +5°C to +25°C in a 65 %  $\pm$  5 % relative humidity atmosphere).

The kit includes the battery, you can purchase only the battery and power supply.

## BATTERIE

### Batterie ricaricabili Ni-Cd e Ni-MH ad alta temperatura.

Le batterie, speciali per sistemi di emergenza, sopportano una carica permanente per almeno 4 anni, in ambienti ad alte temperature (fino a +50°C).

- Corrente costante durante la carica (ELDN T).
- Corrente intermittente durante la carica (ELED).
- Zero manutenzione.
- Ciclo di vita superiore a 500 ricariche.
- Lungo periodo di stoccaggio (fino a 4 mesi in condizioni normali: da +5°C a +25°C con umidità relativa del 65 %  $\pm$  5 %).

Il KIT include la batteria, è possibile acquistare separatamente sia la batteria che l'alimentatore.