

Emergency light KIT for power LED and LED modules
KIT per luce d'emergenza per power LED e moduli LED

Made in Europe

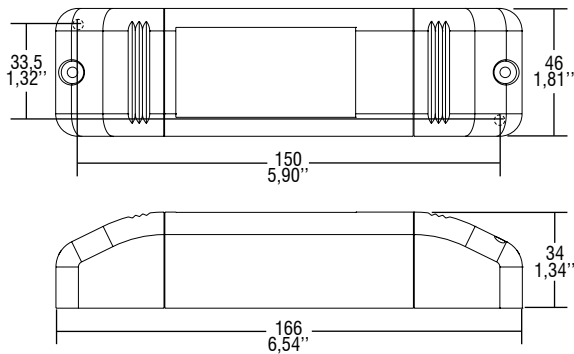

Weight - Peso:
gr. 185 / 6,52 oz.
Pcs - Pezzi 1



Wiring diagrams - Schemi di collegamento

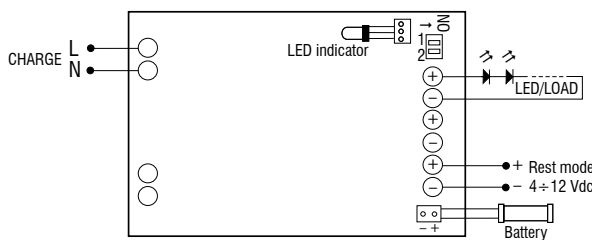

Non-maintained (emergency only) diagram
Collegamento non permanente (solo emergenza)

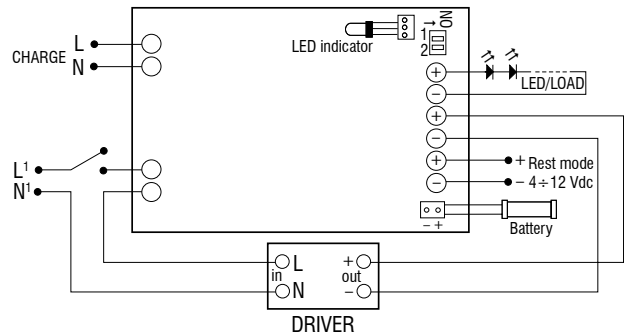

Maintained with external electronic driver diagram
Collegamento permanente (illuminazione ordinaria)

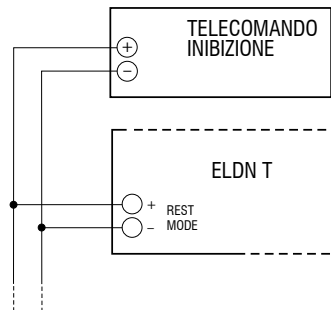

Remote control device diagrams
Collegamento con telecomando esterno centralizzato

Remote control device

It allows both to switch off the emergency lamps during emergency mode. The rest mode is automatically reseted when mains voltage is restored. This remote control device can be installed so as to operate several emergency units at the same time.

Con telecomando esterno centralizzato

Permette lo spegnimento delle lampade durante il funzionamento in emergenza. Al rientro della tensione di rete il sistema si predisporrà ad un nuovo intervento in emergenza.

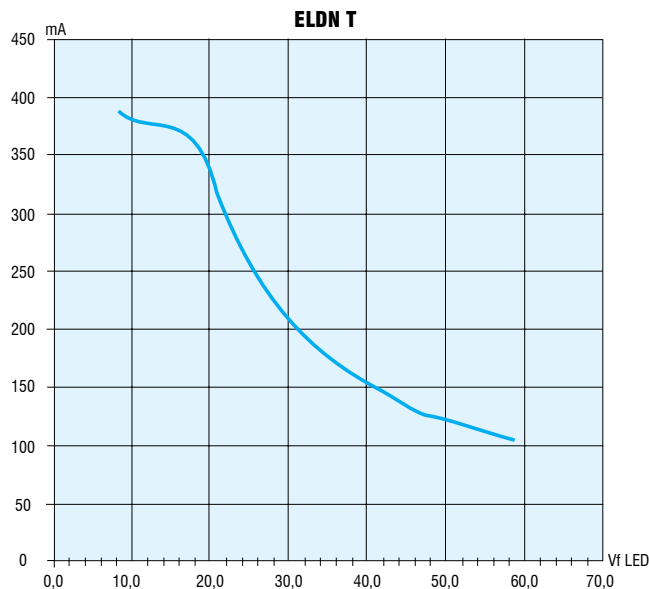

DIP-SWITCH	Working voltage during emergency (V_f) Tensione di lavoro in emergenza (V_f)	Output current during emergency (I) Corrente in uscita in emergenza (I)	n° LED max.	Power max. for LED modules Potenza max. per moduli LED
A	9...12 V	350 ± 10%	3/4	24 W
B	9...24 V	350...250mA	7/8	30 W
C	9...46 V	350...125mA	12/14	-
D	9...58 V	350...100mA	17/18	-