

Conectores

48.281.8300

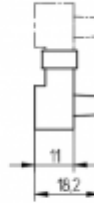

3 polos

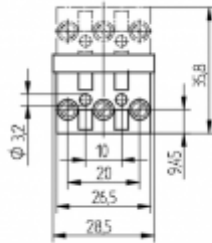
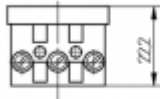
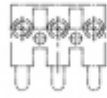

Color	Emb.	Peso	Referencia
negro	1000	8 g	48.281.8300.80

Borne
Fijación por tornillo
Cuerpo: PA 6.6

- Sección nominal: 1,5 mm²
- Corriente nominal: 16 A hasta temperatura ambiental Tu = 85° C

			16 A 400 V
$\phi 3,4$			